



BRISBANE GIRLS GRAMMAR SCHOOL

Add a family member to a Microsoft account

Sign into Microsoft account:

1. Click the 'Family' tab

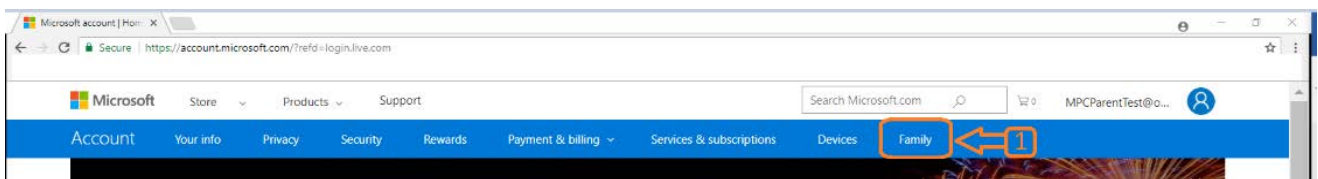

2. Click 'Add a Family Member'

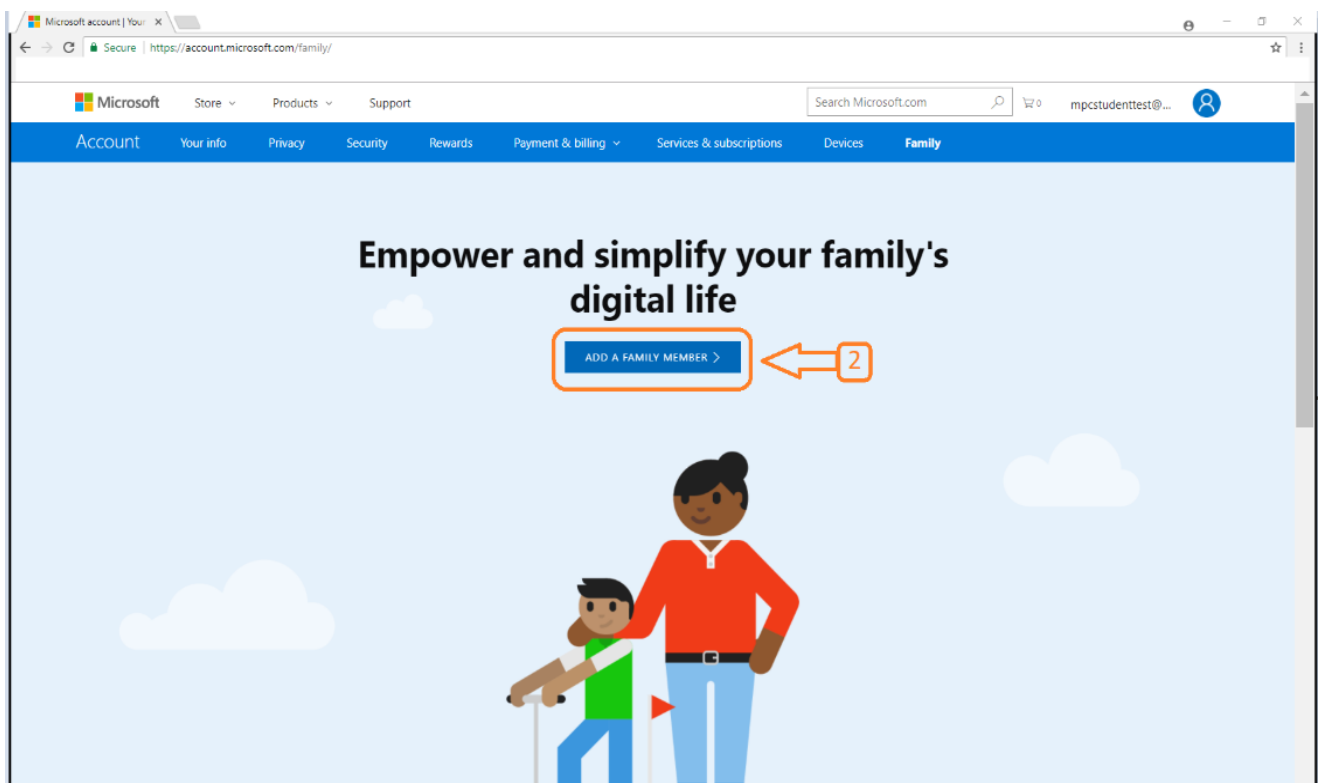

3. Click 'Child'
4. Enter child's email address
5. Type characters



BRISBANE GIRLS GRAMMAR SCHOOL

6. Click 'Send invite'

The screenshot shows a dialog box titled "Add a family member" with a close button (X) in the top right corner. Below the title is a descriptive paragraph: "Invite a member to your Microsoft family. Adults can change kids' settings and keep an eye on their online activity, while kids can enjoy a safer online experience." Below this are two radio buttons: "Child" (selected) and "Adult". An orange box with the number "3" and an arrow points to the "Child" radio button. Below the radio buttons is a text input field labeled "Email or mobile number". An orange box with the number "4" and an arrow points to this field. Below the input field is a "New | Audio" link and a small image of a hand-drawn "NOW LOOK" sign. Below the sign is another text input field labeled "Enter the characters you see". An orange box with the number "5" and an arrow points to this field. Below the input fields are two lines of text: "If they don't have a Microsoft account, create one for them." and "By clicking **Send invite**, you agree to our [Terms](#)." At the bottom right is a blue "Send invite" button. An orange box with the number "6" and an arrow points to this button.

7. Click 'Done'

The screenshot shows a dialog box titled "Invite sent" with a close button (X) in the top right corner. Below the title is the text: "Once they accept, they'll be added to the family." Below this is an icon of an envelope with a green checkmark. At the bottom are two buttons: "Invite another" (disabled, grey) and "Done" (active, blue). An orange box with the number "7" and an arrow points to the "Done" button.

8. Click 'Accept now'



BRISBANE GIRLS GRAMMAR SCHOOL

9. Accept the invitation now – this will sign you out of *your* Microsoft account
Click ‘Accept Now’

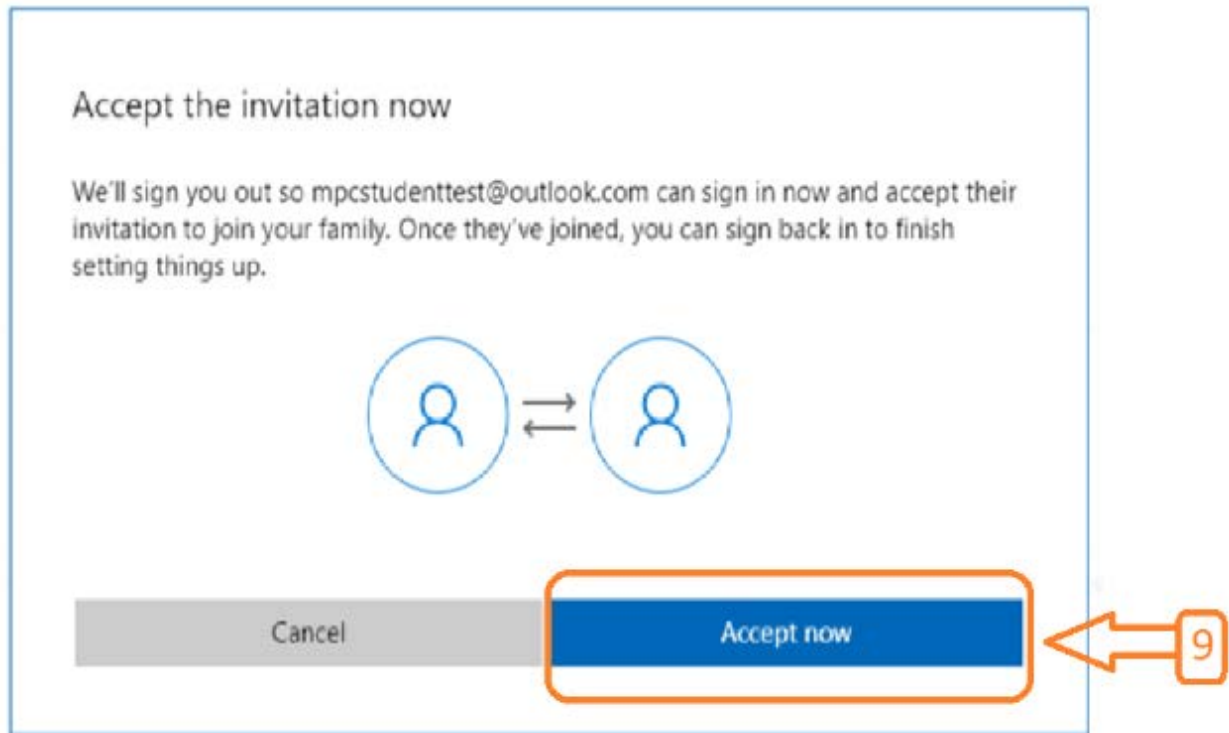

10. Student's email address. If you are not redirected, please use the following link:
<https://account.microsoft.com/account>
11. Enter student's 'password'
12. Click 'Sign in'

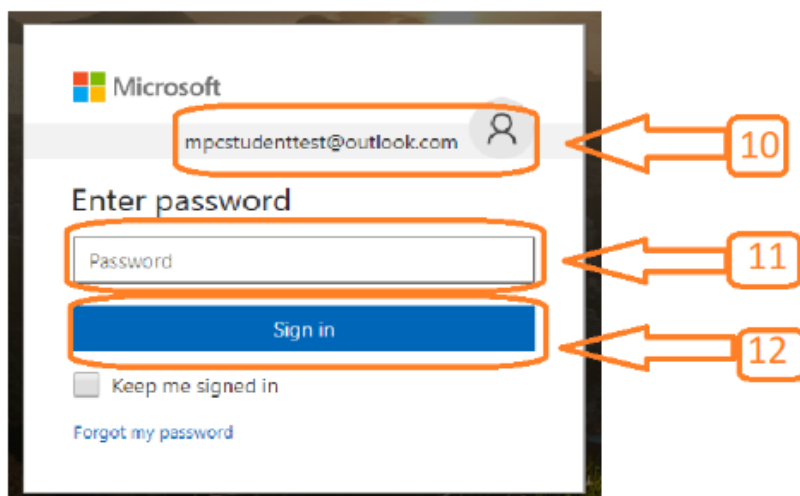



BRISBANE GIRLS GRAMMAR SCHOOL

13. Click 'Yes'

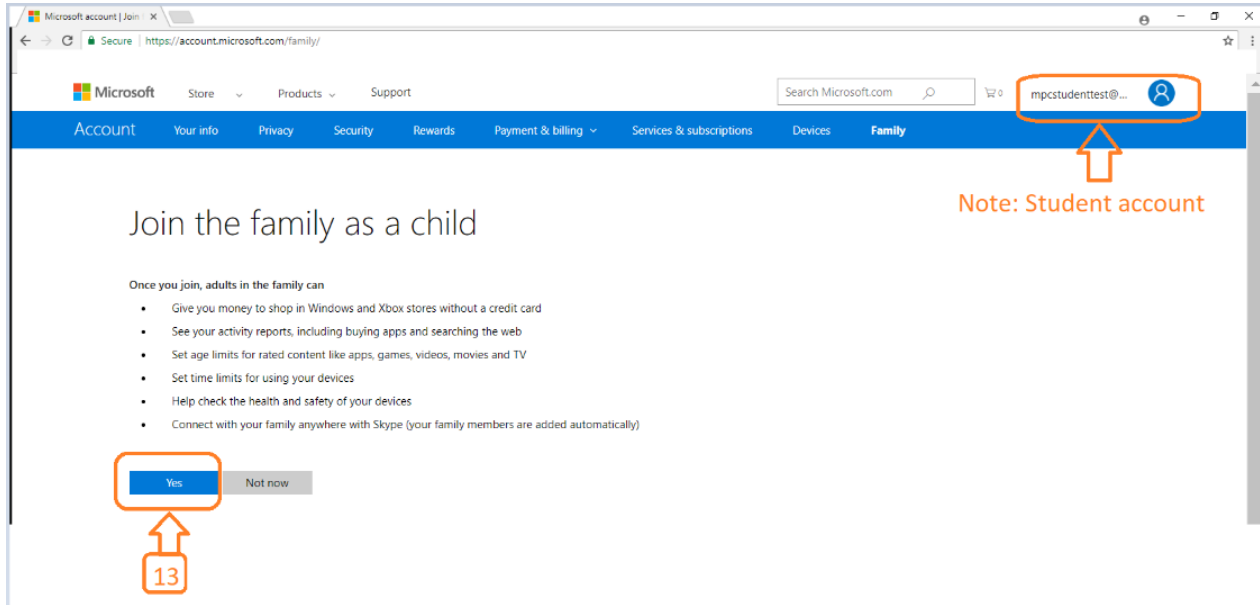

14. If required, please enter the following details for your child.



Add details

We need just a little more info to set up your account.

First name

Last name

Birthdate

Month Day Year

Country/region

United States

[Next](#)

[Terms of Use](#)

[Privacy & Cookies](#)

[Sign out](#)

Microsoft



BRISBANE GIRLS GRAMMAR SCHOOL

15. Click the 'Student' icon
16. Click 'Sign out'

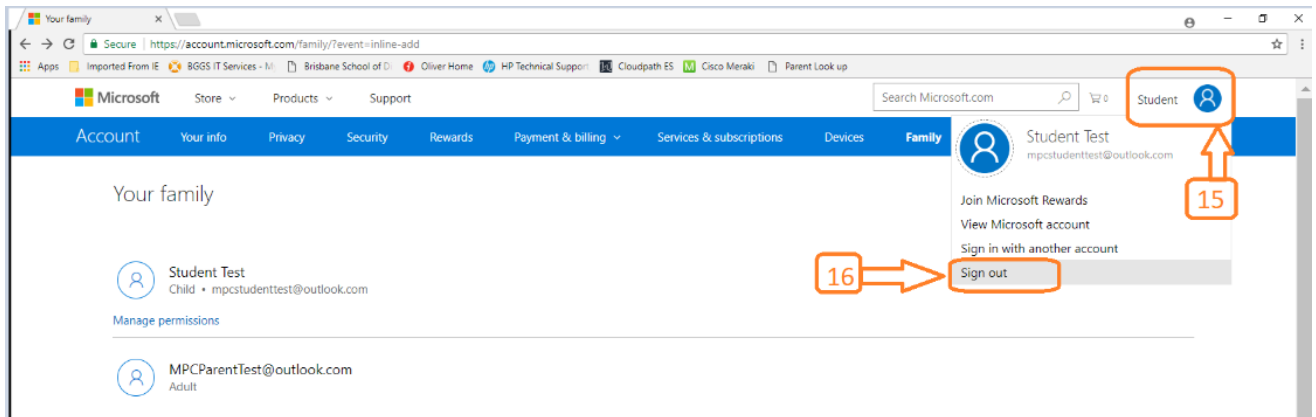

Setting up Parental Controls via Microsoft Account

17. Now sign into your Parent Microsoft account
18. Click 'Sign in'

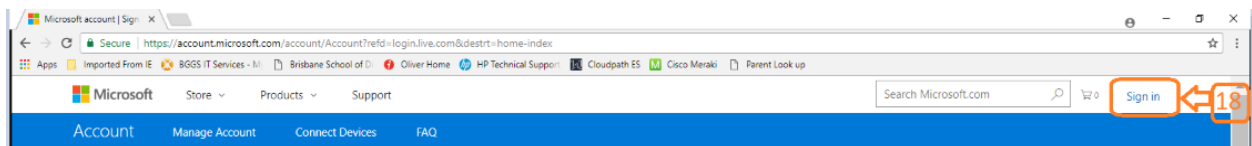

19. Enter your email address
20. Click 'Next'

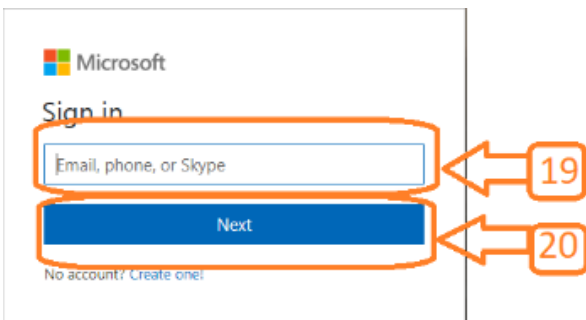

21. Enter password
22. Click 'Sign in'

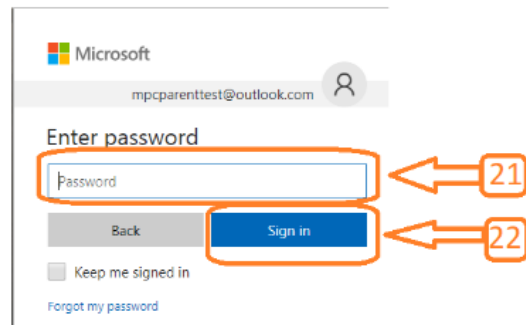



BRISBANE GIRLS GRAMMAR SCHOOL

23. Click the 'Family' tab

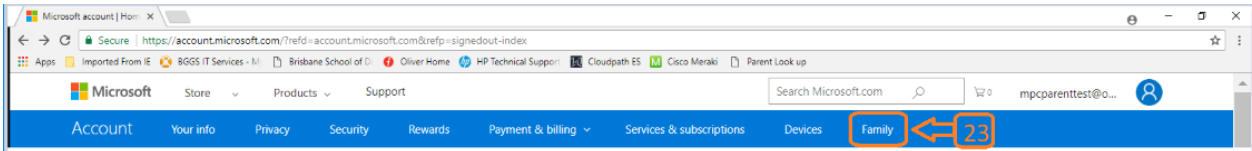

24. You can now set up Parental Control for your child's device. Click 'More Options'

